



Coil Thread Sup-R-Drop®



Coil Thread Sup-R-Drop®

Available Materials

- Carbon steel, zinc plated

Features/Advantages

- Ideal for form work and tilt-up bracing
- Accepts 1/2" or 3/4" standard coil thread rod or coil thread bolts
- Preassembled for ease of installation
- Slotted body is precision-matched to tapered internal plug for uniform expansion
- Knurled body increases frictional forces between anchor and wall of hole

Concerns

- Dead load only
- Hole depth must be equal to anchor length
- Do not over torque

Approvals/Listings

- G.S.A. Spec FF-S-325C, Group VIII, Type 1
- Contact customer service for approvals

Order Detail

| Order Code | Bolt Dia. | Min. Embed. | Hole Dia. | Max Torque (ft. lbs.) | Ultimate Tensile & Shear Loads in Lbs. | | | | Box Qty. | Master Qty. |
|------------|-----------|-------------|-----------|-----------------------|--|--------------|----------------|--------------|----------|-------------|
| | | | | | 2000 P.S.I. | | 4000 P.S.I. | | | |
| | | | | | Tension (lbs.) | Shear (lbs.) | Tension (lbs.) | Shear (lbs.) | | |
| 1312CT0 | 1/2" | 2" | 5/8" | 20 | 5,312 | 5,854 | 7,398 | 5,854 | 50 | 250 |
| 1334CT0 | 3/4" | 3 3/16" | 1" | 80 | 12,300 | 11,627 | 16,019 | 11,627 | 10 | 50 |

Installation of Coil Thread Sup-R-Drop®

- 1 Drill hole same length as anchor. Do not use core bits. Maintain accurate hole diameter.
- 2 Clean hole of debris.
- 3 Drop in anchor, slotted end first.
- 4 To set, drive setting tool into anchor until shoulder of tool is flush with top of anchor.
- 5 Select appropriate coil thread rod or coil bolt.

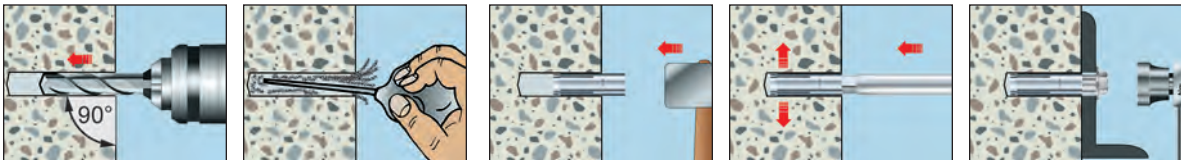

Contact Hurripanel Fasteners for a Quote
1.972.417.8882 • www.hurripanel.com